

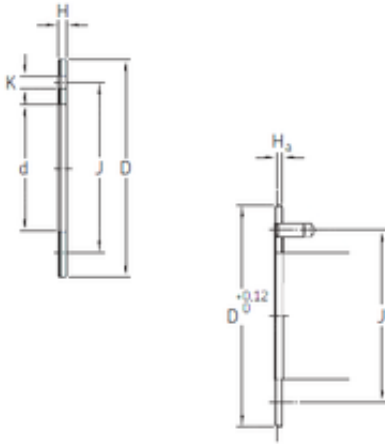

# XSY Bearing Co., Ltd.

## SKF PCMW 223801.5 M plain bearings



Bearing No. PCMW 223801.5 M

PCMW 223801.5 M Bearing 2D drawings and 3D CAD models

Size	22x38x1.5 mm
Bore Diameter	22 mm
Outer Diameter	38 mm
Width	1,5 mm
d	22 mm
D	38 mm
H	1,5 mm
J	30 mm
K	3,25 mm
Ha min.	1 mm
Weight	0,0077 Kg
Basic dynamic load rating (C)	90 kN
D <sub>a</sub>	38 mm
J <sub>a</sub>	30 mm
H <sub>a</sub>	1 mm
Basic dynamic load rating - radial direction C	90 kN
Basic static load rating - radial direction C <sub>0</sub>	186 kN
Specific dynamic load factor K	120 N/mm <sup>2</sup>
Specific static load factor K <sub>0</sub>	250 N/mm <sup>2</sup>
Factor depending on material and bearing type K <sub>M</sub>	1900
Permissible sliding velocity v max.	2.5 m/s



## XSY Bearing Co., Ltd.

Permissible sliding velocity v min.	0 m/s
Coefficient of friction $\mu$ max.	0.2
Coefficient of friction $\mu$ min.	0.02
Mass thrust washer	0.0077 kg